

# Empowerment Toolkit

November 2024

# Key Integration Milestones

We have accomplished a lot this year – and we are near the finish line!

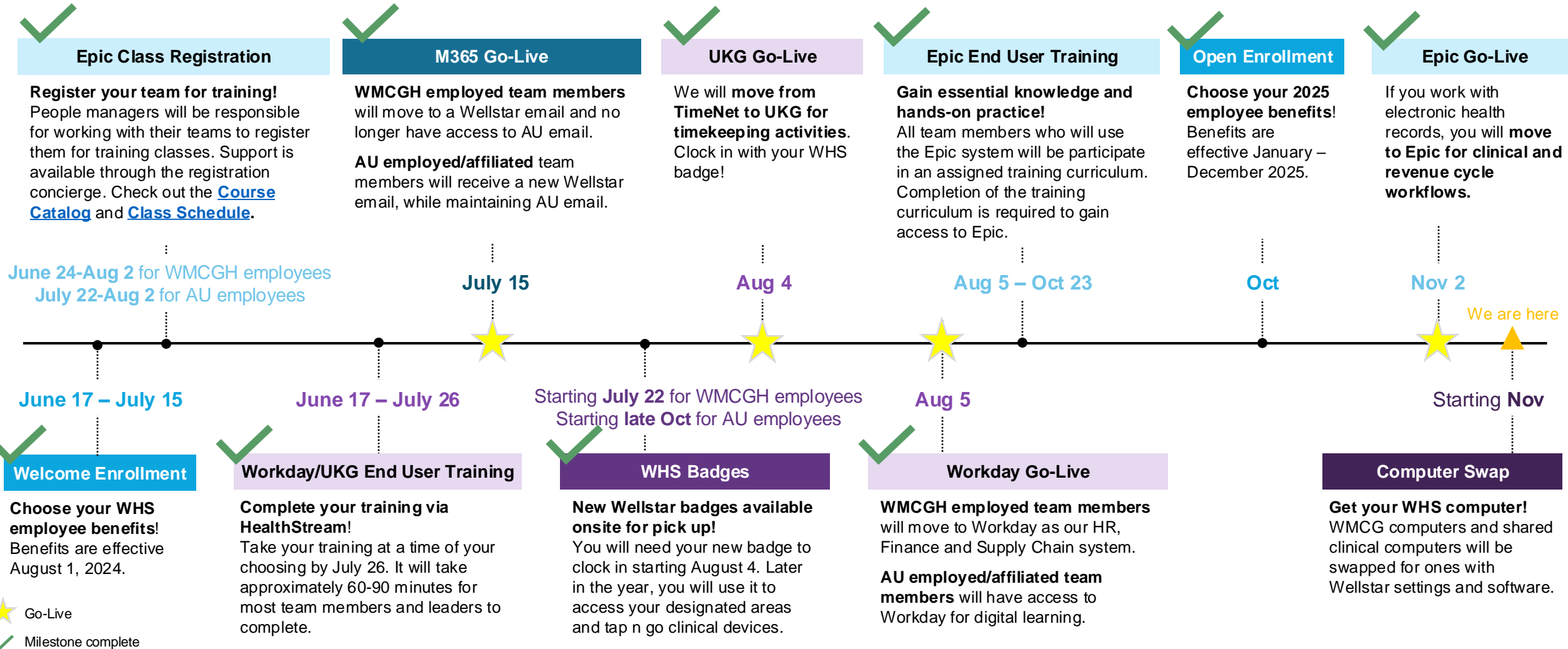

# The end of the integration is near – this is the final toolkit!

Look to your manager for future updates or refer to the information shared during the integration.

## Welcome to Wellstar MCG Website

Check out what's available at  
<https://welcometowellstarmcg.com/>

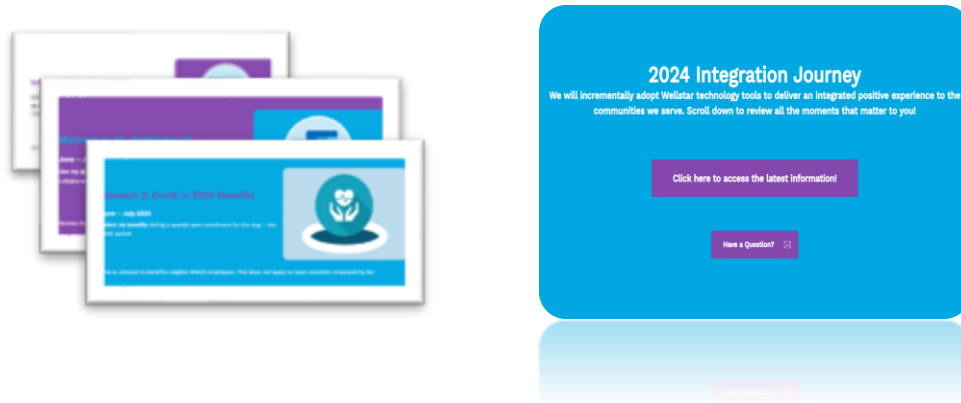

*You can find resources shared along our journey, such as ongoing communications and readiness checklists*

## Epic Resources

Find resources and tip sheets on the [Epic Connect](#) website



*You can also access Tip Sheets using the button in Epic.*

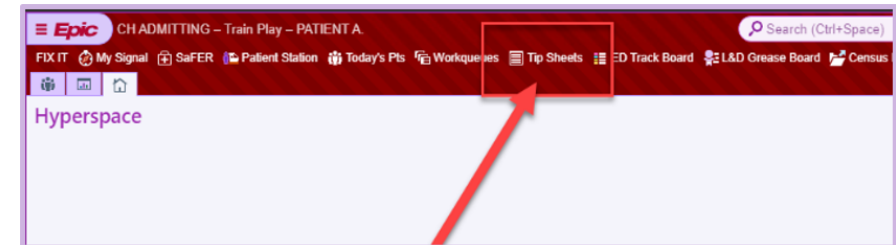

# Epic Refresher Training

Self-guided courses are available to strengthen and refresh your Epic knowledge.

## What to Expect



The embedded Amplifire courses take learning a step further, using randomized questions to identify gaps in knowledge



You will get instant feedback and access to additional resources like videos or explanations for any missed answers



Questions are repeated to reinforce understanding

Role	Link
ED Physicians and APPs	<a href="#">Link</a>
Ambulatory Physicians and APPs	<a href="#">Link</a>
Inpatient Physicians and APPs	<a href="#">Link</a>
Inpatient OBGYN Physicians and APPs	<a href="#">Link</a>
Inpatient Surgeons	<a href="#">Link</a>
Inpatient Nurses	<a href="#">Link</a>
Ambulatory Clinical Support Staff	<a href="#">Link</a>

*Click on the applicable link to access the course via Workday.*

# Need support?

Resources are available to you!

## Clinical Informatics

### Inpatient

Call **(762) 375 – 8818** to speak to a CIS team member Monday to Friday, 7:00am to 5:00pm EST

### Outpatient

Call **(706) 721 – 4707**, choose **option 3**, to speak to a CIS team member Monday to Friday, 7:00am to 5:00pm EST

After hours urgent / emergent issues will be triaged by the Service Desk.

## WALi [Wellstar Automated Library chatbot](#)



Chat with WALi with your technical questions.

To access WALi:

- Open Wellstar Teams
- Click on the WALi logo in the left-side toolbar

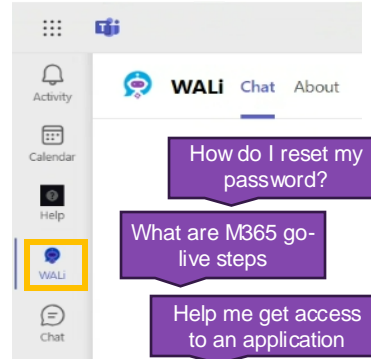

## In-App Guidance

### Workday or UKG

If accessing via Wellstar Desktop, click on the ? at the right to be taken to online guidance.



### Epic

Submit a ServiceNow ticket via the Epic FIX IT widget.



## ServiceNow

Submit help requests for Wellstar applications.

To access ServiceNow:

- Click on the Wellstar Desktop icon on your desktop
- Go to [esource.wellstar.org](https://esource.wellstar.org)
- Click on the ServiceNow link

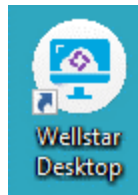

**servicenow**

## Wellstar Integration Support

Contact for questions or issues related to IT (e.g., system access, applications) or requisitions for supplies or services.



**1-7500**

## Wellstar HR Service Center

Contact for questions or issues related to HR, time management or payroll.



[Employee Resource Portal](#)



**470-267-1234**